

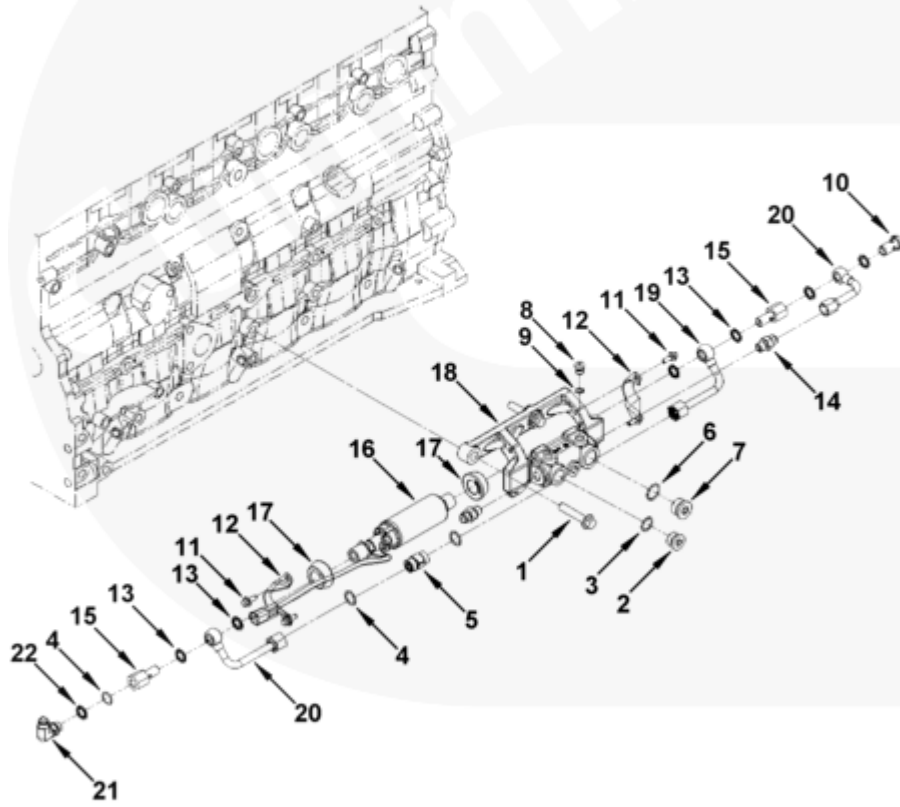

Parts Catalog - Option Detail

Electronic Parts Catalog - Option Detail				
Option	Group	Graphic	Film Card	Date
FS90096-03	06.05	fs965gu	T	02-MAY-12
Engines	4B3.9, 6A3.4, 6B5.9, B GAS INTERNATIONAL CM556, B4.5, B4.5 CM2350 B129B, B4.5 CM2350 B146C, B4.5 CM2350 B147B, B4.5 RGT, B4.5S, B5.9 G, B5.9 GAS PLUS CM556, B5.9 LPG, B5.9 LPG PLUS CM556, B6.7 CM2350 B121B, B6.7 CM2350 B135B, B6.7 CM2350 B136C, B6.7 CM2350 B148B, B6.7 G CMOH6.0 B125, B6.7N CM2380 B150B, B6.7S, F3.8 CM2350 F120B, F3.8 CM2350 F128C, F3.8 CM2350 F132B, F3.8 F102, G3.9, G5.9, G5.9 CM558, ISB (CHRYSLER), ISB CM2150, ISB CM2150 E, ISB CM550, ISB CM850, ISB/ISD4.5 CM2150 B119, ISB/ISD4.5 CM2150 SN, ISB/ISD6.7 CM2150 B120, ISB/ISD6.7 CM2150 SN, ISB/ISD6.7 CM2880 B126, ISB3.9 CM2220 B107, ISB4.5 CM2150, ISB5.9G CM2180, ISB6.7 2010 DCX PICKUP, ISB6.7 2013 DCX CHASSIS CAB, ISB6.7 CM2150 SQ, ISB6.7 CM2250, ISB6.7 CM2350 B101, ISB6.7 CM2350 B103, ISB6.7 CM2350 B142, ISB6.7 CM2670 B153B, ISB6.7 G CM2180 B118, ISBE CM2150, ISBE CM800, ISBE2/ISBE3 CM850, ISBE4 CM850, ISD4.5 CM2150, ISD6.7 CM2880 D101, ISF2.8 CM2220, ISF2.8 CM2220 AN, ISF2.8 CM2220 EC, ISF2.8 CM2220 ECF2, ISF2.8 CM2220 F101, ISF2.8 CM2220 F117, ISF2.8 CM2220 F122, ISF2.8 CM2220 F126, ISF2.8 CM2220 F129, ISF2.8 CM2220 IAN, ISF3.8 CM2220, ISF3.8 CM2220 AN, ISF3.8 CM2220 F103, ISF3.8 CM2220 F110, ISF3.8 CM2220 F116, ISF3.8 CM2220 F134B, ISF3.8 CM2220 IAN, ISF3.8 CM2350 F109, ISF4.5 CM2220 F123, ISG11 CM2880 G106, ISG11 CM2880 G108, ISG12 CM2880 G107, ISG12 CM2880 G109, ISG12 G CMOH6.0 G111, QSB3.9 30 CM550, QSB3.9 CM2880 B138, QSB4.5 30 CM550, QSB4.5 CM2150 B108, QSB4.5 CM2250 B131, QSB4.5 CM2250 EC, QSB4.5 CM2350 B106, QSB4.5 CM2350 B122			



fs965gu

SMALL | MEDIUM | LARGE

Cart	Ref No	Part Number	Part Description	Required	Remarks
View My Cart					
		FS90096-03	Fuel Transfer Pump		Fuel Transfer Pump...(More)
					Engine Cylinders: 6
					Engine Family: "B" Series
					fuel transfer pump voltage:
					12.
	1	3910540	Hexagon Flange Head Cap Screw	2	
<input type="checkbox"/>		5284446	Fuel Transfer Pump	1	
<input type="checkbox"/>		3046202	Threaded Plug	1	3/4 - 16 UNF.
	2	3040810	Threaded Plug	1	

<input type="checkbox"/>	3	3046201	O-Ring Seal	1	
<input type="checkbox"/>		5286583	Check Valve	1	
<input type="checkbox"/>	4	3922794	O-Ring Seal	2	
	5	5284447	Check Valve	1	
<input type="checkbox"/>		3040815	Threaded Plug	1	7/18 - 14 UNF
<input type="checkbox"/>	6	3040817	O-Ring Seal	1	
	7	3040816	Threaded Plug	1	Service as 3040815
<input type="checkbox"/>		3678923	Threaded Plug	2	M10 X 1.00 X 13.5
<input type="checkbox"/>	8	3678924	Threaded Plug	2	M10 X 1.00 X 13.5
<input type="checkbox"/>	9	3678925	O-Ring Seal	1	M10.
<input type="checkbox"/>	10	3903035	Banjo Connector Screw	1	M12 X 1.50 X 24.
<input type="checkbox"/>	11	3913638	Hexagon Flange Head Cap Screw	4	M6 X 1.00 X 16.
<input type="checkbox"/>	12	3955110	Transfer Pump Bracket	2	
<input type="checkbox"/>	13	3963990	Sealing Washer	6	M12.
<input type="checkbox"/>	14	4010861	Male Connector	2	
<input type="checkbox"/>	15	4942529	Banjo Connector Screw	2	
<input type="checkbox"/>	16	5260632	Fuel Transfer Pump	1	Serviced as 4955799
<input type="checkbox"/>	17	3955114	Vibration Isolator	2	
<input type="checkbox"/>	18	5284445	Transfer Pump Bracket	1	
<input type="checkbox"/>	19	5284448	Fuel Transfer Tube	1	
<input type="checkbox"/>	20	5284449	Fuel Transfer Tube	2	
<input type="checkbox"/>		5285993	Male Connector	1	
<input type="checkbox"/>	4	3922794	O-Ring Seal	1	
	21	5284450	Male Connector	1	
<input type="checkbox"/>	22	3103224	Retaining Ring	1	
<input type="checkbox"/>		4955799	Lift Pump Kit	A/R	